



Integrated Device Technology, Inc.
6024 Silver Creek Valley Road, San Jose, CA - 95138

PRODUCT/PROCESS CHANGE NOTICE (PCN)

PCN #: A0808-02R2 DATE: 25-Aug-2010 Product Affected: VFQFP-N-64 and VFQFP-N-72 (Standard and Green) Date Effective: 27-Sep-2008	MEANS OF DISTINGUISHING CHANGED DEVICES: <input type="checkbox"/> Product Mark <input checked="" type="checkbox"/> Back Mark Lot # will have "U", "P", "D", "I", "Y" or <input type="checkbox"/> Date Code "CH" prefix. <input type="checkbox"/> Other
--	---

Contact: Bimla Paul Title: Product Quality Assurance Phone #: (408) 574-6419 Fax #: (408) 284-8362 E-mail: Bimla.Paul@idt.com	Attachment: <input checked="" type="checkbox"/> Yes <input type="checkbox"/> No Samples: Please contact your local sales representative for sample request & availability.
--	--

DESCRIPTION AND PURPOSE OF CHANGE:

<input type="checkbox"/> Die Technology <input type="checkbox"/> Wafer Fabrication Process <input checked="" type="checkbox"/> Assembly Process <input type="checkbox"/> Equipment <input type="checkbox"/> Material <input type="checkbox"/> Testing <input checked="" type="checkbox"/> Manufacturing Site <input type="checkbox"/> Data Sheet <input type="checkbox"/> Other	<p>Revision 2: This revised PCN is to include package dimensions for VFQFP-N-72 for clarification and to update part# list per latest product availability.</p> <p>The PCN effective date remains unchanged.</p> <p>A copy of the Revision 1 is attached.</p>
---	--

RELIABILITY/QUALIFICATION SUMMARY:
Refer to qualification data shown in page 17.

CUSTOMER ACKNOWLEDGMENT OF RECEIPT:

IDT records indicate that you require written notification of this change. Please use the acknowledgement below or E-Mail to grant approval or request additional information. If IDT does not receive acknowledgement within 30 days of this notice it will be assumed that this change is acceptable.

IDT reserves the right to ship either version manufactured after the process change effective date until the inventory on the earlier version has been depleted.

Customer: _____	<input type="checkbox"/> Approval for shipments prior to effective date.
Name/Date: _____	E-Mail Address: _____
Title: _____	Phone# /Fax# : _____

CUSTOMER COMMENTS: _____

IDT ACKNOWLEDGMENT OF RECEIPT:

RECD. BY: _____ DATE: _____



Integrated Device Technology, Inc.
6024 Silver Creek Valley Road, San Jose, CA - 95138

PRODUCT/PROCESS CHANGE NOTICE (PCN)

ATTACHMENT I - PCN #: A0808-02R2

Affected Part Number

Part Number	Part Number	Part Number	Part Number
932S509HKLF	9ERS3165BKILFT	9LPRS356AKLF	9ZX21501CKLF
932S509HKLFT	9ERS3165BKLF	9LPRS356AKLFT	9ZX21501CKLFT
932S820CKLF	9ERS3165BKLF	9LPRS528CKLF/W	9ZX21901BKLF
932S820CKLFT	9EX21501AKILF	9LPRS914HKLF	9ZX21901BKLFT
932S890CKLF	9EX21501AKILFT	9LPRS914HKLFT	9ZX21901CKLF
932S890CKLFT	9EX21501AKLF	9LRS3165BKILF	9ZX21901CKLFT
932SQ420CKLF	9EX21501AKLFT	9LRS3165BKILFT	9FG1900AK-1LF
932SQ420CKLFT	9EX21531AKLF	9LRS3165BKLF	9FG1900AK-1LFT
9CPS4700AKLF	9EX21531AKLFT	9LRS3165BKLF	9FG1900BK-1LF
9CPS4700AKLFT	9EX21831AKLF	9LRS4880AKLF	9FG1900BK-1LFT
9DB1904BKLF	9EX21831AKLFT	9LRS4880AKLFT	9FG1900AK-2LF
9DB1904BKLFT	9LPRS134BKLF	9LVRS387AKLF	9FG1900AK-2LFT
9DB1933AKLF	9LPRS134BKLF	9LVRS387AKLFT	9FG1900AK-3LF
9DB1933AKLFT	9LPRS140AKLF	9VRS4818AKLF	9FG1900AK-3LFT
9EPRS488CKLF	9LPRS140AKLFT	9VRS4818AKLFT	
9EPRS488CKLFT	9LPRS140CKLF	9ZX21501BKLF	
9ERS3165BKILF	9LPRS140CKLFT	9ZX21501BKLFT	

Note 1: This is the newly added part# list based on latest product availability. Please refer to attached PCN Revision 1 for previously published part# list.

REVISIONS				
DCN	REV	DESCRIPTION	DATE	APPROVED
	03	CHANGED b DIM IN NL/72	05/06/05	PKP
	04	CHANGED D2 & E2	10/19/06	PKP
	05	ADDED 88-LEAD	08/30/07	PKP
	06	ADD PUNCH VERSION 5 PAGES	09/02/08	MA
	07	PUNCH VERSION UP-DATE: COMBINE PAGE 6 AND 7 TOGETHER ADD 64, 68 and 88L VARIANT ON PAGE 6 UPDATE COMMON DIMENSION TABLE PAGE 6 UPDATE TOOTH NUMBER TABLE PAGE 6 UPDATE NOTE ON PAGE 7	05/17/10	MR

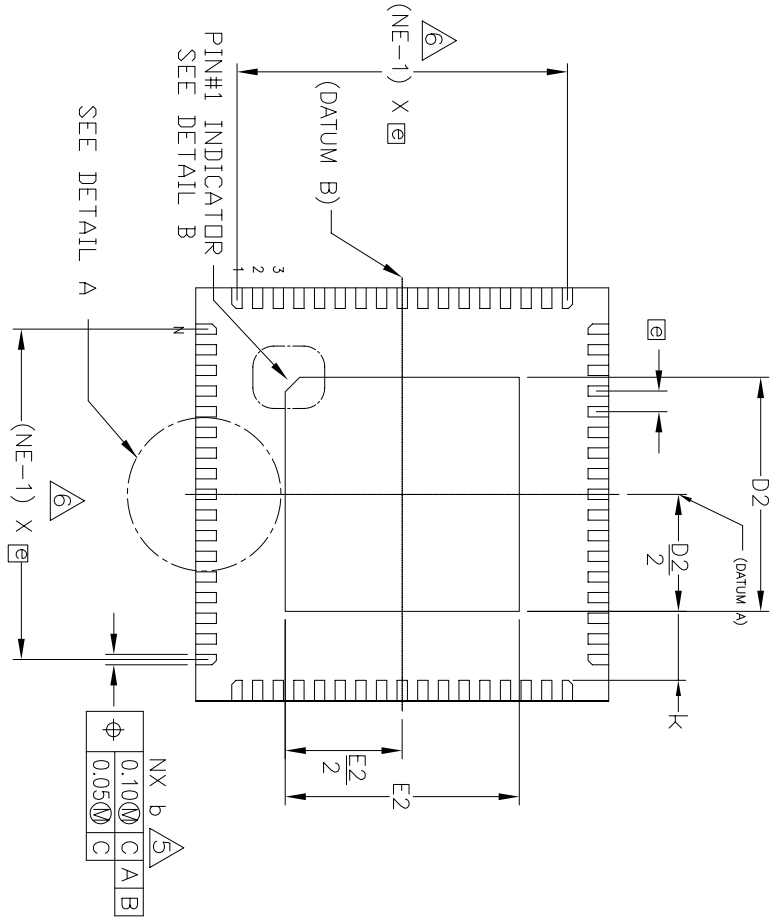
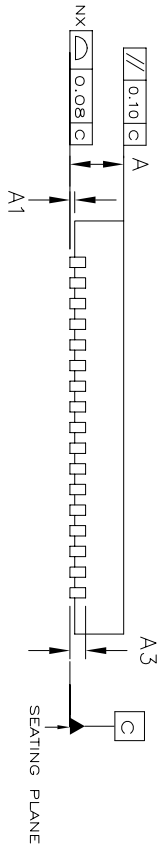
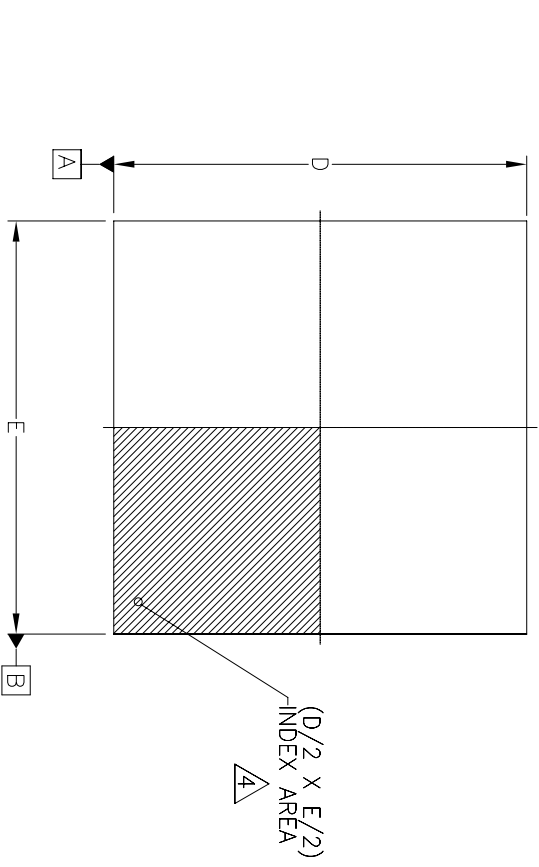

TOLERANCES UNLESS SPECIFIED

DECIMAL ±

ANGULAR ±

XXXX±

XXXX±

APPROVALS DATE TITLE

DRAWN *DPY/p* 05/06/02 N/L/NIG PACKAGE OUTLINE

CHECKED VFQFP-N

SIZE C DRAWING No. PSC-4111

DO NOT SCALE DRAWING SHEET 1 OF 7

IDT™ www.IDT.com

6024 Silver Creek Valley Rd
San Jose, CA 95138
PHONE: (408) 284-8200
FAX: (408) 284-3572

REVISIONS				
DCN	REV	DESCRIPTION	DATE	APPROVED
03	03	CHANGED b DIM IN NL72	05/06/05	PKP
04	04	CHANGED D2 & E2	10/19/06	PKP
05	05	ADDED 88-LEAD	08/30/07	PKP
06	06	ADD PUNCH VERSION 5 PAGES	09/02/08	MA
07	07	PUNCH VERSION UP-DATE: FIX DRAWING ON PAGE 4 COMBINE PAGE 6 AND 7 TOGETHER ADD 64, 68 and 88L VARIANT ON PAGE 6 UPDATE COMMON DIMENSION TABLE PAGE 6 UPDATE TOL FORM & POSITION TABLE PAGE 6 UPDATE NOTE ON PAGE 7	05/17/10	MR

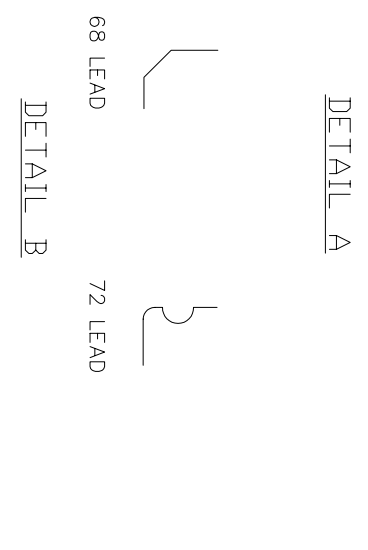
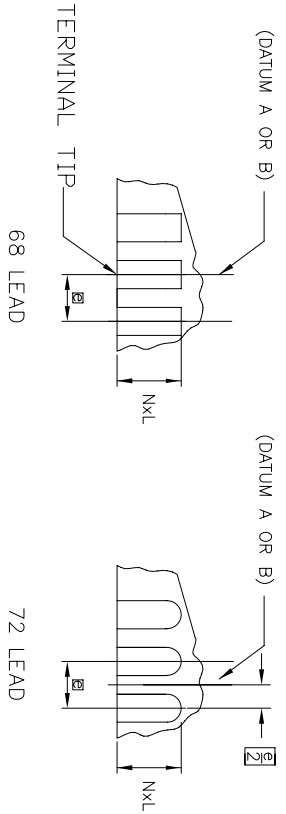

SAW VERSION:

Symbol	NL68			NL72			NL88			No. of Terminals
	MIN.	NOM.	MAX.	MIN.	NOM.	MAX.	MIN.	NOM.	MAX.	
A	0.80	0.90	1.00	0.80	0.90	1.00	0.80	0.90	1.00	8
A1	0.00	0.02	0.05	0.00	0.02	0.05	0.00	0.02	0.05	8
A3	0.20 REF.			0.20 REF.			0.20 REF.			5
b	0.18	0.25	0.30	0.18	0.23	0.28	0.15	0.20	0.25	5
D	10.00 BSC			10.00 BSC			10.00 BSC			8
E	10.00 BSC			10.00 BSC			10.00 BSC			8
D2	SEE NOTE			5.85	6.00	6.15	7.95	8.10	8.25	8
E2	SEE NOTE			5.85	6.00	6.15	7.95	8.10	8.25	8
K	0.20	-	-	0.20	-	-	0.20	-	-	8
L	0.45	0.50	0.55	0.35	0.40	0.45	0.30	0.40	0.50	8
N	0.50 BSC			0.50 BSC			0.40 BSC			6
Nd	68	72	88	72	88	88	88	88	88	6
Nd	17	18	18	18	18	18	22	22	22	6
Ne	17	18	18	18	18	18	22	22	22	6

NOTES:

- DIMENSIONING & TOLERANCING CONFORM TO ASME Y14.5M-1994.
- ALL DIMENSIONS ARE IN MILLIMETERS. ANGLES ARE IN DEGREES.
- N IS THE TOTAL NUMBER OF TERMINALS.
Nd IS THE NUMBER OF TERMINALS IN X-DIRECTION & Ne IS THE NUMBER OF TERMINALS IN Y-DIRECTION.
- THE TERMINAL #1 IDENTIFIER AND TERMINAL NUMBERING CONVENTION SHALL CONFORM TO JEDEC PUB. 95 SEC. 4.3 SPP-002. DETAILS OF TERMINAL #1 IDENTIFIER ARE OPTIONAL, BUT MUST BE LOCATED WITHIN THE ZONE INDICATED. THE TERMINAL #1 IDENTIFIER MAY BE EITHER A MOLD OR MARKED FEATURE.
- DIMENSION b APPLIES TO METALLIZED TERMINAL AND IS MEASURED BETWEEN 0.25mm AND 0.30mm FROM TERMINAL TIP.
- ND AND NE REFER TO THE NUMBER OF TERMINALS ON EACH D AND E SIDE RESPECTIVELY.
- DEPOPULATION IS POSSIBLE IN A SYMMETRICAL FASHION.
- DIMENSIONS D2 & E2 VARY DEPENDING ON DEVICE. SEE DEVICE DATASHEET.

TOLERANCES UNLESS SPECIFIED			6024 Silver Creek Valley Rd San Jose, CA 95138 PHONE: (408) 284-8200 FAX: (408) 284-3572
DECIMAL	ANGULAR		
±	±	www.IDT.com	
APPROVALS	DATE	TITLE	
DRAWN <i>DP</i>	05/06/02	NL/NLG PACKAGE OUTLINE	
CHECKED		10.0 X 10.0 mm BODY	
		SIZE	DRAWING No.
		C	PSC-4111
			REV
			07

REVISIONS				
DCN	REV	DESCRIPTION	DATE	APPROVED
	03	CHANGED b DIM IN NL/72	05/06/05	PKP
	04	CHANGED D2 & E2	10/19/06	PKP
	05	ADDED 88-LEAD	08/30/07	PKP
	06	ADD PUNCH VERSION 5 PAGES	09/02/08	MA
	07	PUNCH VERSION UP-DATE: FIX DRAWING ON PAGE 4 COMBINE PAGE 6 AND 7 TOGETHER ADD 64, 68 and 88L VARIANT ON PAGE 6 UPDATE COMMON DIMENSION TABLE PAGE 6 UPDATE TOL. FORM & POSITION TABLE PAGE 6 UPDATE NOTE ON PAGE 7	05/17/10	MR

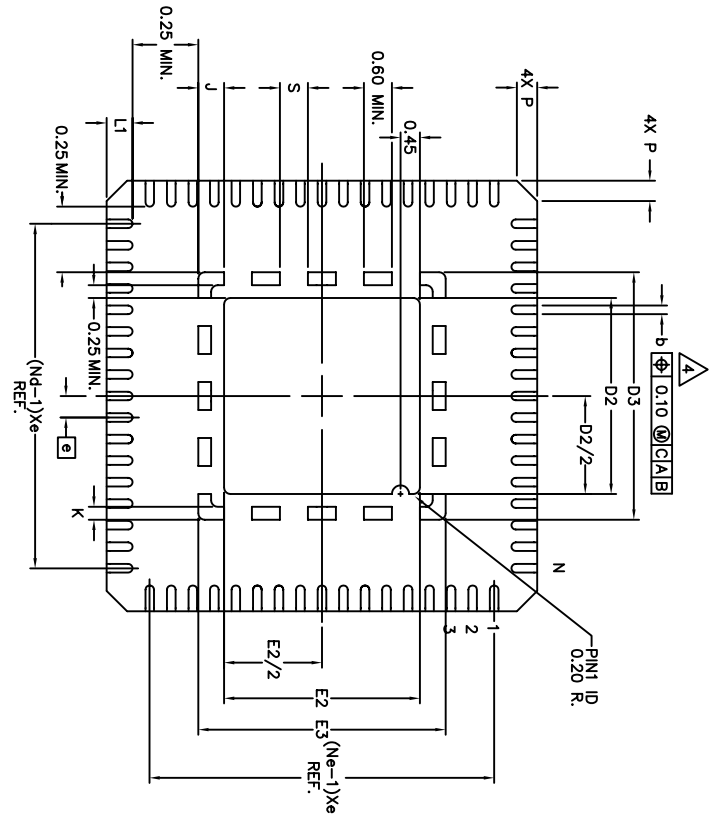

APPLIES TO MIXED RING PAD OPTION NL68 ONLY			
Symbol	MIN.	NOM.	MAX.
D2	4.40	4.55	4.70
E2	4.40	4.55	4.70
D3	5.60	5.75	5.90
E3	5.60	5.75	5.90
P	0.24	0.42	0.60
K	0.20	0.30	0.40
S	0.50	0.60	0.65
J	0.60	1.00	1.50
N		68	3
Nd		17	3
Ne		17	3
L1	0.50	0.60	0.75

MIXED RING PAD OPTION

TOLERANCES UNLESS SPECIFIED
 DECIMAL ANGULAR
 XXX± ±
 XXXXX± ±

APPROVALS DATE TITLE
 DRAWN: PXP/DP 05/06/02
 CHECKED: VFQFP-N

SIZE: C DRAWING No.: PSC-4111
 DO NOT SCALE DRAWING SHEET 3 OF 7

WWW.IDT.COM

IDT 6024 Silver Creek Valley Rd
 San Jose, CA 95138
 PHONE: (408) 284-8200
 FAX: (408) 284-3572

PUNCH VERSION:

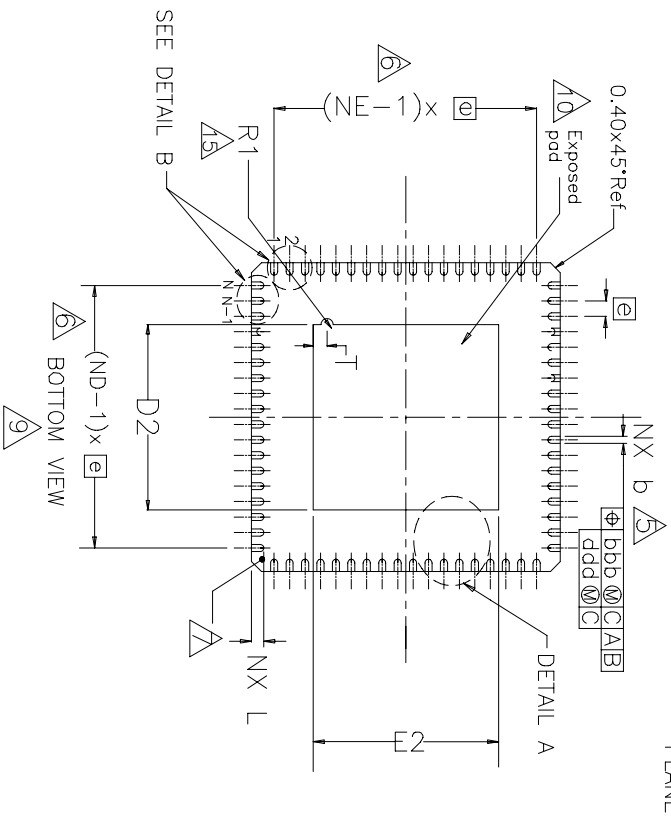
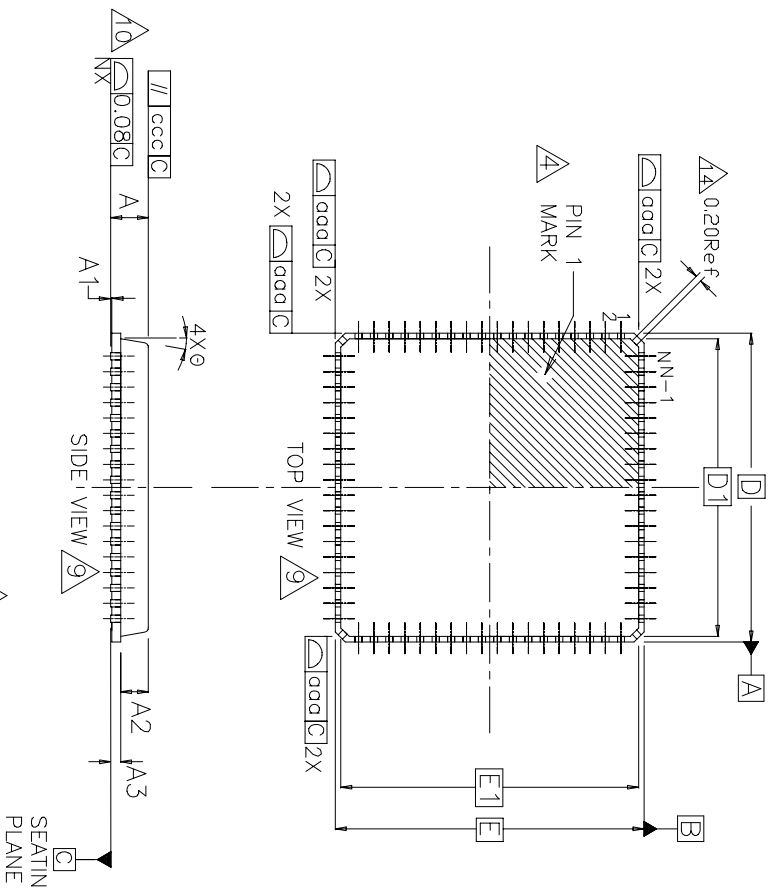

REVISIONS				
DCN	REV	DESCRIPTION	DATE	APPROVED
	03	CHANGED b DIM IN NL72	05/06/05	PKP
	04	CHANGED D2 & E2	10/19/06	PKP
	05	ADDED 88-LEAD	08/30/07	PKP
	06	ADD PUNCH VERSION 5 PAGES	09/02/08	MA
	07	PUNCH VERSION UP-DATE: FIX DRAWING ON PAGE 4 COMBINE PAGE 6 AND 7 TOGETHER ADD 64, 68 and 88L VARIANT ON PAGE 6 UPDATE COMMON DIMENSION TABLE PAGE 6 UPDATE COMMON DIMENSION TABLE PAGE 6 UPDATE NOTE ON PAGE 7	05/17/10	MR

TOLERANCES UNLESS SPECIFIED			
DECIMAL	ANGULAR	6024 Silver Creek Valley Rd San Jose, CA 95138 PHONE: (408) 284-8200 FAX: (408) 284-3572	
XXXX±	±	www.IDT.com	
APPROVALS	DATE	TITLE NL/NLG PACKAGE OUTLINE 10.0 X 10.0 mm BODY V/QFP-N	
DRAWN <i>DP</i>	05/06/02	SIZE C DRAWING No. PSC-4111	
CHECKED		DO NOT SCALE DRAWING	
		SHEET 4 OF 7	

REVISIONS				
DCN	REV	DESCRIPTION	DATE	APPROVED
	03	CHANGED b DIM IN NL/72	05/06/05	RKP
	04	CHANGED D2 & E2	10/19/06	RKP
	05	ADDED 88-LEAD	08/30/07	RKP
	06	ADD PUNCH VERSION 5 PAGES	09/02/08	MA
	07	PUNCH VERSION UP-DATE: FIX DRAWING ON PAGE 4 COMBINE PAGE 6 AND 7 TOGETHER ADD 64, 68 and 88L VARIANT ON PAGE 6 UPDATE COMMON DIMENSION TABLE PAGE 6 UPDATE TOL FORM & POSITION TABLE PAGE 6 UPDATE NOTE ON PAGE 7	05/17/10	MIR

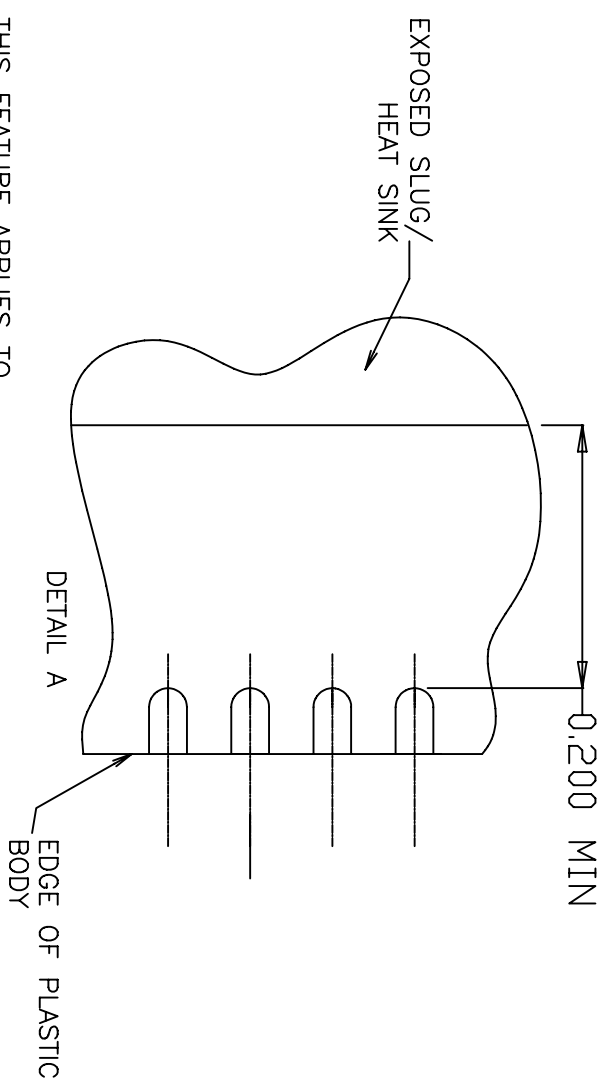
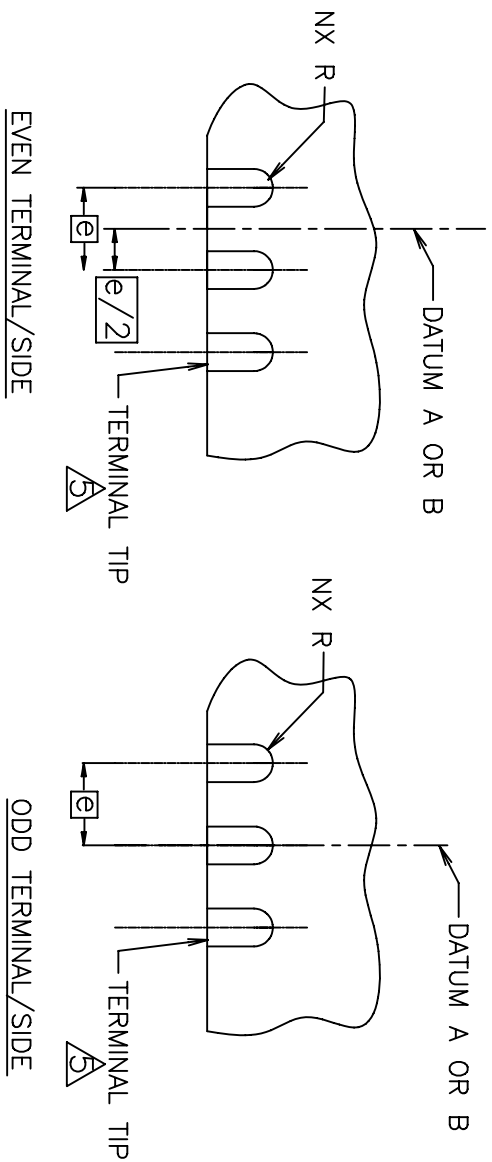

THIS FEATURE APPLIES TO ALL ENDS OF THE PKG.

TOLERANCES UNLESS SPECIFIED				6024 Silver Creek Valley Rd San Jose, CA 95138 PHONE: (408) 284-8200 FAX: (408) 284-3572	
DECIMAL	ANGULAR	www.IDT.com			
XXX±	±	TITLE NL/NIG PACKAGE OUTLINE			
XXXX±		10.0 X 10.0 mm BODY			
APPROVALS	DATE	DRAWING No. PSC-4111			
DRAWN PXP/p	05/06/02	SIZE C			
CHECKED		DO NOT SCALE DRAWING			
		SHEET 5 OF 7			

